

18,551



Farmers Electric Cooperative

2000 I-30 E
Greenville, TX 75402

FILED FOR RECORD
at 1:30 o'clock P M

DEC 27 2023

BECKY LANDRUM
County Clerk, Hunt County, Tex.
By 

Friday, December 15, 2023

County: Hunt County

Farmers Electric Cooperative Member: CRAIG PORTZ
Service Order Number: 2023106315

Greetings:

Farmers Electric Cooperative, Inc. is requesting permission to construct electrical power distribution facilities which will cross County Road 2216.

Site location map/construction sketches are attached. The construction sketch details the proposed work. The proposed electrical service will be constructed:

- Overhead - All road crossings will have a minimum vertical clearance of 22 feet.
- Underground - All underground bore crossings are PVC encased 4' of coverage from the lowest point of the Right of Way.

If you have any questions, please contact me at any time.

Sincerely,

Brandon Darrow
bdarrow@farmersselectric.coop
Engineering Coordinator

Enclosures

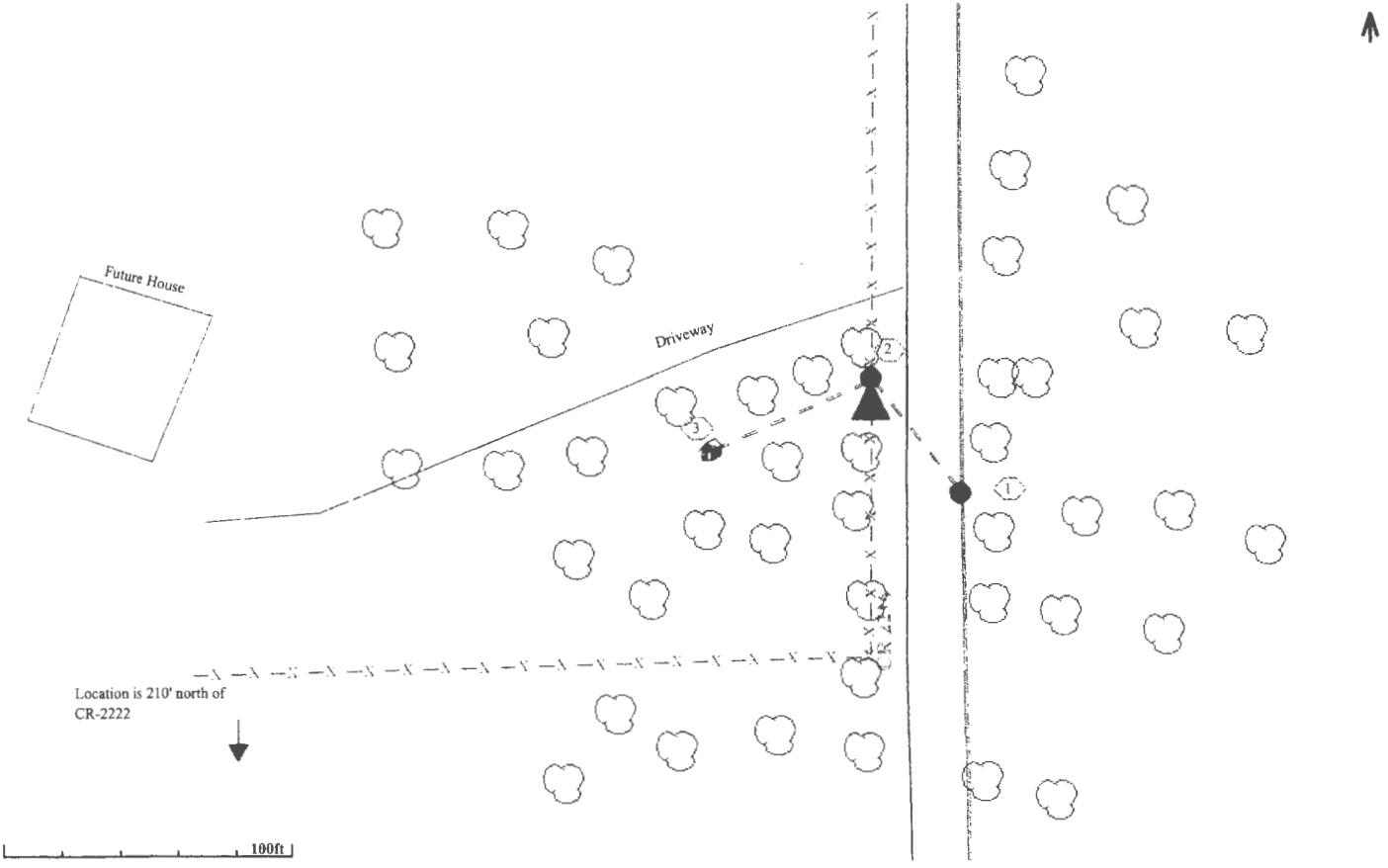

Future House

Driveway

Location is 210' north of
CR-2222

100ft